



DAROCA  
DESIGN



# EQUILIBRIUM

## 105MT EXPLORER YACHT

Equilibrium is a 105 m explorer yacht and 16,5 m beam with 6 decks. Equilibrium can welcome up to 22 guests who will have plenty of space to relax and enjoy. It include 1 Owners cabin, 4 VIP cabin and 6 Guest cabins. And it can accommodate up to 42 crew members.



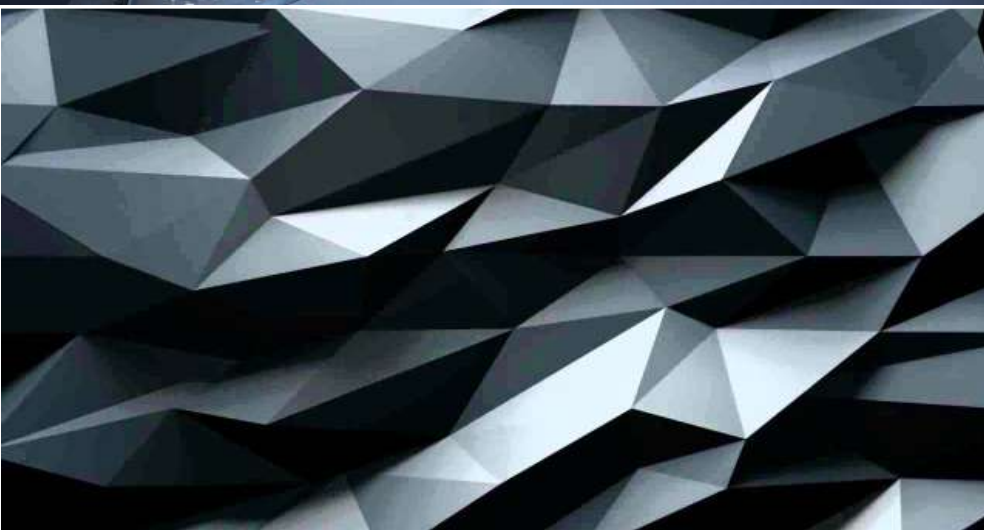

Equilibrium represents the flawless combination between the strength and elegance of its lines. Her modern design stands out due to her simplicity, pure beauty and practicality.

The name Equilibrium indicates indeed what she tries to instill. The optimal balance between an "explorer yacht" features and a "pleasure yacht" luxuries.

Her design is meticulously thought to fit in any type of environment. From the coldest corners of the Antarctica, to the warmest and most joyful places of the Caribbean.

Her aesthetic is inspired by faceted architecture. This concept creates a strong sense of movement and dynamism that translates into an art of lights and shadows.

Furthermore, her interior design creates a perfect relation between wood and cement. This combination is purely aimed to represent the harmony by transmitting the delicacy of the warmth and harmony from the wood along with the coldness and artificiality from the cement.

Her magnificent straight lines and the quantity of windows provide an extraordinary touch of natural light to the interior. This generates a sensation of full range of space and wideness.

The color of the m/y Equilibrium is champagne-green. A unique color-scheme that stands out due to its shiny shades. At sunset, this color creates a perfect match with the metallic-white tone on the upper part.

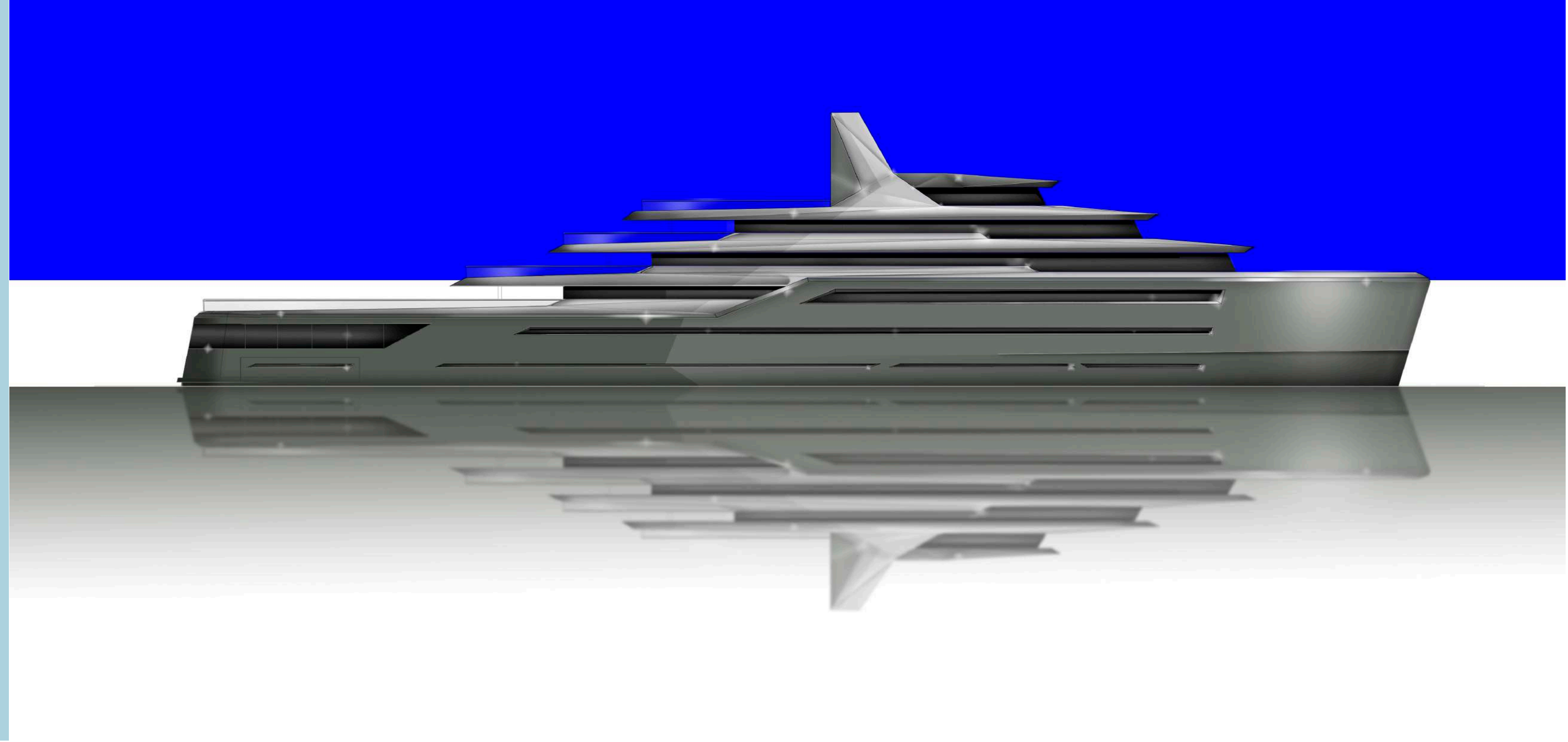











The Bridgedeck is equipped with a 13,6x16m helipad surface located on the upper aft deck. The helipad is designed for the landing of different models of Airbus ACH, which will allow exploring unique destinations as well as welcoming guests with a touch of style. In addition, there is a hangar designed to protect the helicopter from the weather.

The Owners deck has an outdoor jacuzzi surrounded by an environment that invites you to relax next to the sun beds and enjoy a cocktail in any of the two bars. It is the ideal space for pleasure and entertainment on board.

On the Upper deck there is a large terrace with a big table that provides you with the luxury of a great outdoor evening. It also has an additional space for sitting right next to an outstanding feature: a fountain that falls like a waterfall to the main pool of the yacht.

The 15x7m outdoor pool with a glass bottom is located in the Maindeck. It is definitely an idyllic scene with multiple possibilities. Enjoying a swim, sunbathing on the hammocks or drinking a fresh cocktail in any of the sofas while having a breathtaking experience with the view.

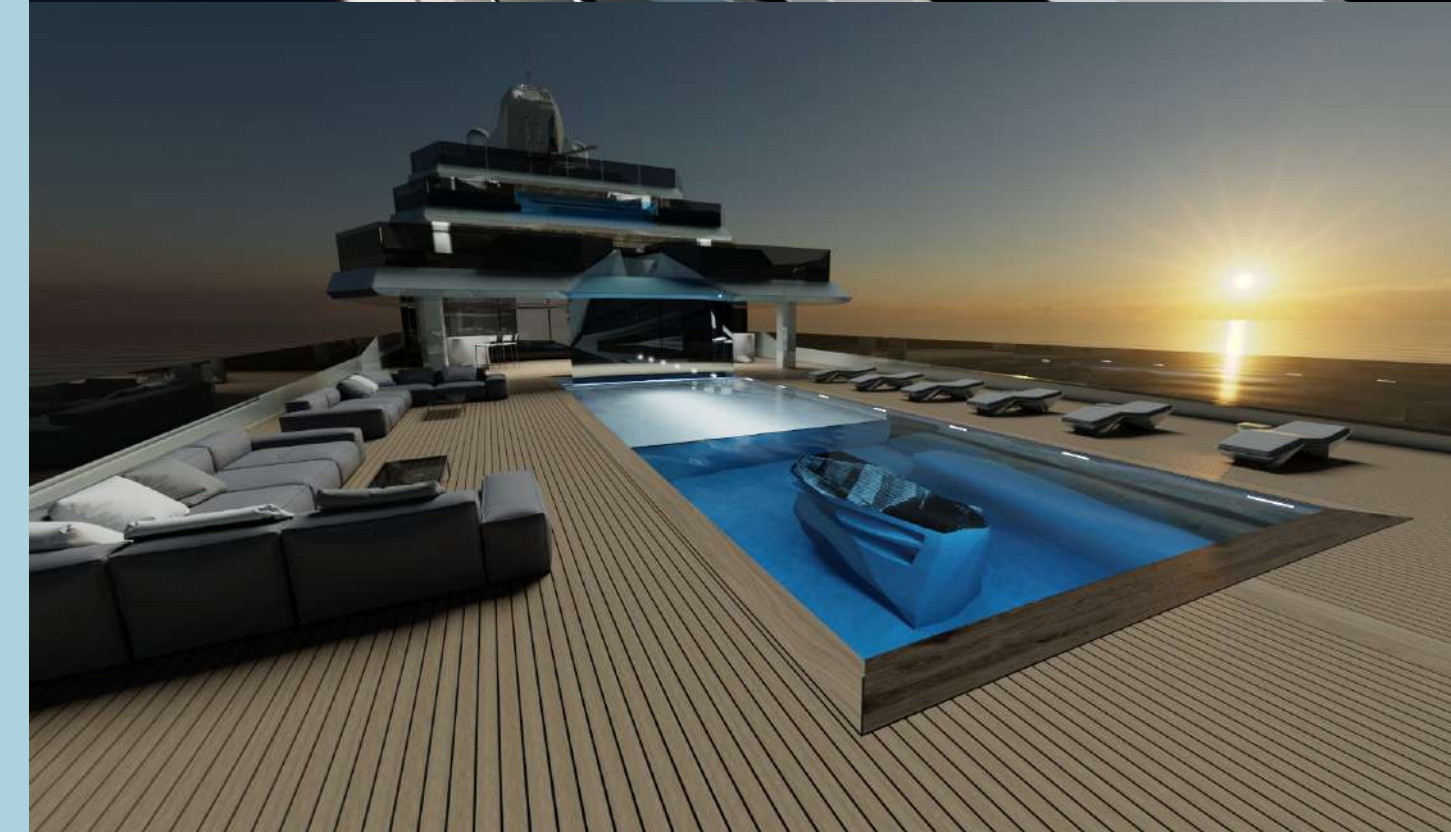













One of the highlights of m/y Equilibrium is the aft area, where you can find two decks alongside one another, the Nightclub and the Beachclub.

The Nightclub constitutes an impressive panoramic observatory of tempered glass that provides an exterior view of 270 degrees. It is indeed a very special place at any time of the day and surely will host unforgettable celebrations.

Another key design element is the unique roof of the Nightclub, which is the bottom of the pool from the Maindeck. In addition, its geometric design based on triangles and indirect lights achieves a perfect relation of depths and an innovative visual effect that won't surely go unnoticed.

The Beachclub has access from the Nightclub. It has three folding doors that make the space feel connected with the sea. It's the perfect place for a chill out experience while overseeing the amazing views.

The Beachclub includes a large jacuzzi integrated within the deck. In addition, the space has a lounge area as well as two bars.

Comfort on board is always a priority, which is why m/y Equilibrium is also equipped with a Sauna and Hammam area. There is also a scuba diving center located at starboard side as well as an underwater observatory at port side. Both provide a great opportunity to see, feel and know more about the amazing and unexplored sea life.





# SUN SET

## 80MT MOTOR YACHT

Sunset is a personal project designed to improve existing skills working in different softwares as well as working in different scaled yachts. It is a 80 m boat with 4 decks designated to achieve maximum comfort on board and a 13 m beam. Sunset can welcome up to 16 guests who will have plenty of space to relax and enjoy. And it can accommodate up to 30 crew members. Crew members has given good living quarters, including en-suite cabins and a good crew mess. A helicopter pad positioned at the bow with a diameter of 9m.

2018 WINNER  
**EUROPEAN  
PRODUCT  
DESIGN  
AWARD**

[www.productdesignaward.eu](http://www.productdesignaward.eu)

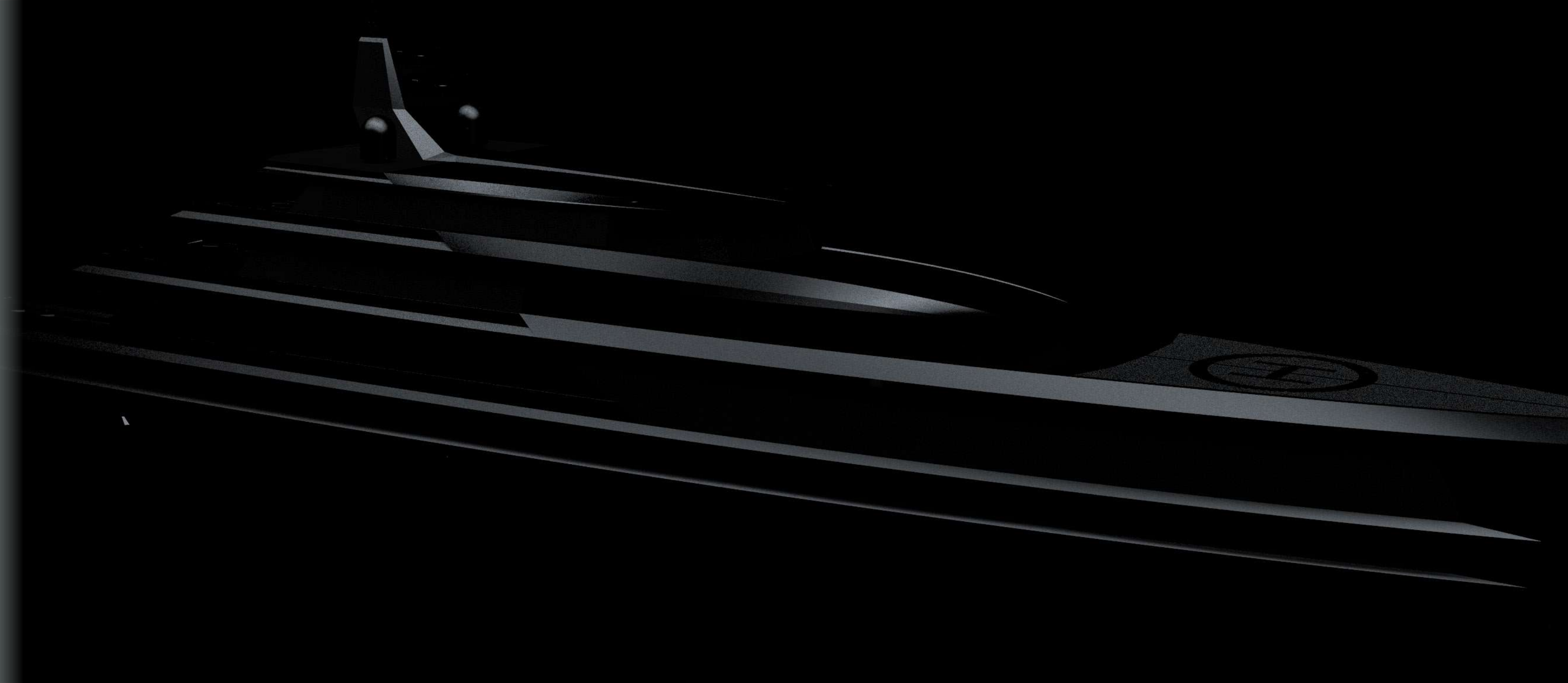





Preserve the balance and the harmony of the inspiration, Sunset can be defined as pleasing, splendid and strong. Her graceful exterior lines are settled into her perfectly. A boat felt really open airy and appealing even to the untrained eye. Her smoked glass windows are there to give an appearance to be lower in height. Indoor-outdoor spaces are designated to be in a perfect balance for the maximum comfort.



The boat is in ivory cream gel coat, in a pearl finish, needless to say that, she will fit naturally with its surroundings. There are glass openings on the superstructures' hardtop, integrated with sunshades that deploy automatically through the day in need. Full height windows on the main deck enables to get as much as natural light to the interior and clears the boundary between indoor and outdoor spaces.

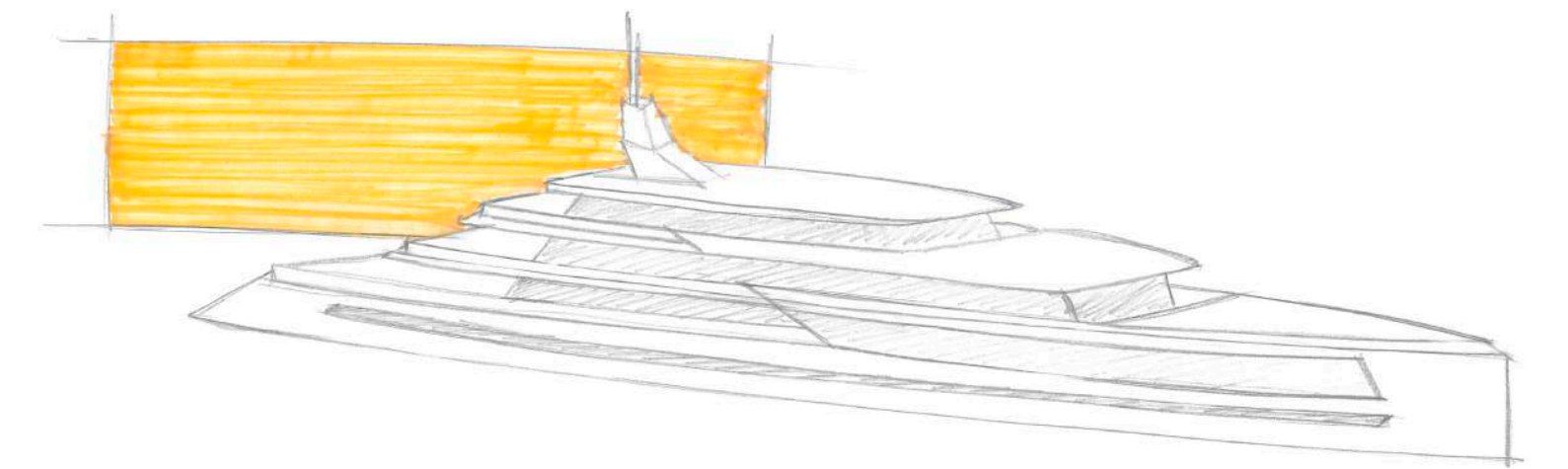
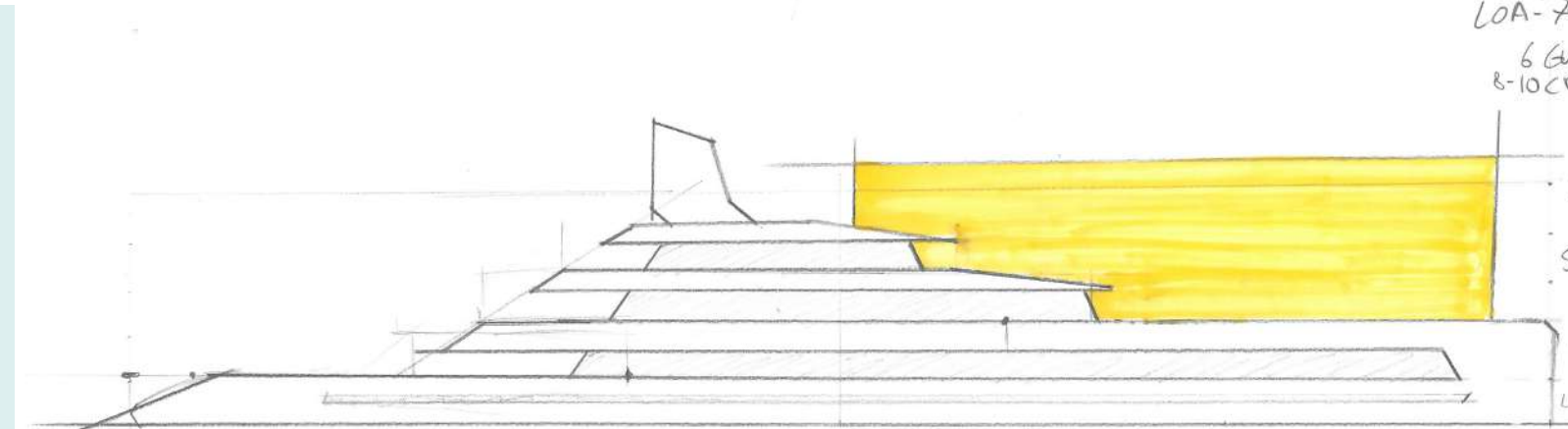













PROFILE

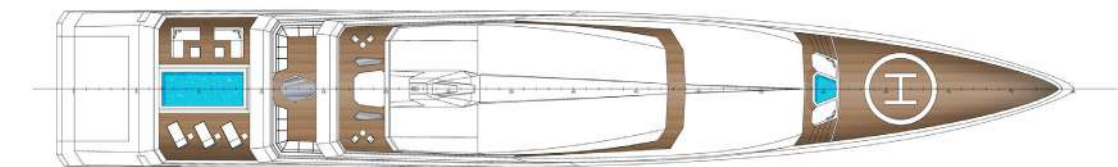

TOP VIEW



BRIDGE DECK

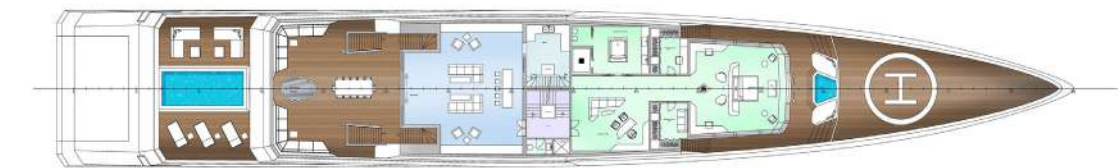

OWNER'S DECK

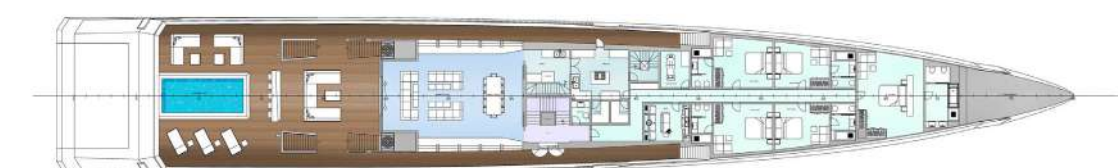

MAIN DECK

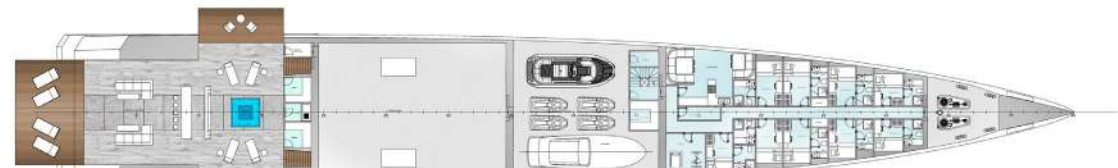

LOWER DECK







Sunset has multiple all fresco dining options that can welcome 12 guests easily and an expansive deck-areas that easily converts from lounging to party mode. 7m to 3m pool with concealed LED lighting arouses luxurious elegance at the first glance. While one side consists a generous lounge area, other side is equipped with sunbeds, offering guests enough the freedom onboard.

On the upper aft deck keeps the fine line between practicality and style. It is included a big dinner table and a big sitting area.

Sundeck, consists of a gym in indoors and an exterior deck area that offers outstanding views. Openings on the floor are specially thought to get more natural light on main deck and to give an extraordinary touch to the sundeck. Snuggle into ultra soft bedding on board on sundeck to enjoy the views in the night time and to sun bath in day time.











Aft section is dedicated to a spacious beach club. Shifts in flooring materials are there to define spaces in an elegant way. The massive beach club bar offers space for a genuine get together. Bar combines a spa pool with a cozy nook aft for more private drinks and a secondary lounge area. Details Are fluid and balanced.

As can be seen from the renders, pool leads to a spa area on both sides with glass sliding door entrances. Spa area is certainly worthy of the name with a sauna, Turkish bath and a Jacuzzi.

The bottom of the main deck pool leads to an unconventional view from the beach club area from the ceiling. There are 2 glass panels that contains running water combined with the back of the sundeck area that keeps the nautical feeling in a luxurious term and creates a feeling of a waterfall.

There are balconies on both sides that enables guests and owners to enjoy panoramic views and leads to a really open and airy environment.





# ZEFIRO

43MT MOTOR YACHT

Zefiro is the absolute opposite of ordinary. She has a planning hull of 41 m, strikingly sober lines and harmoniously balanced volumes. Flowing yet powerfully aggressive lines clothe the Zefiro. Lending it an animal-like grace.







A personal yacht that avoided all the usual references to the world of yachting; kind of military with very clean lines which doesn't look overdesigned. Layered angles are used as a promise of speed, combined with seafaring grace. The 3 deck is designed in a way that guests will enjoy total privacy and crew complete freedom of movement. Interior is designed to lending a sense of roomy airness & chilled-out elegance.

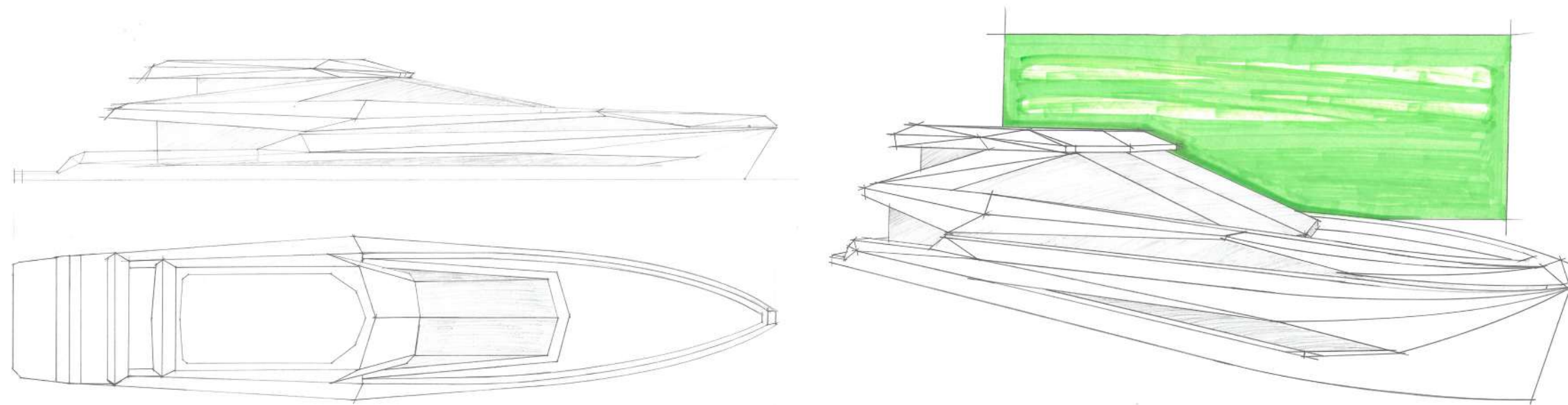













In this yacht, 8 guests are accommodated in 4 cabins. All the 4 cabins are in the lower deck. The master suite lies on the forward main deck, in an extremely privileged position. The main deck is occupied entirely by the day area—in other words conversation and dining areas and kitchen. This enabled to lavish the attention on the social spaces.

The muscularity and dynamism of the craft's lines are very much part of its DNA that is observable inside and out. Interiors and exteriors are melded with the fluidity and continuity of the spaces.

Another essential point was keeping in equilibrium of both shaded and sunny areas. There is also an opening skylight over the king-size bed.

Our entire team's aim is to push conventional boundaries. This is a craft that introduces a strong personality. An unusual but functional yacht that is masculine and intimate.





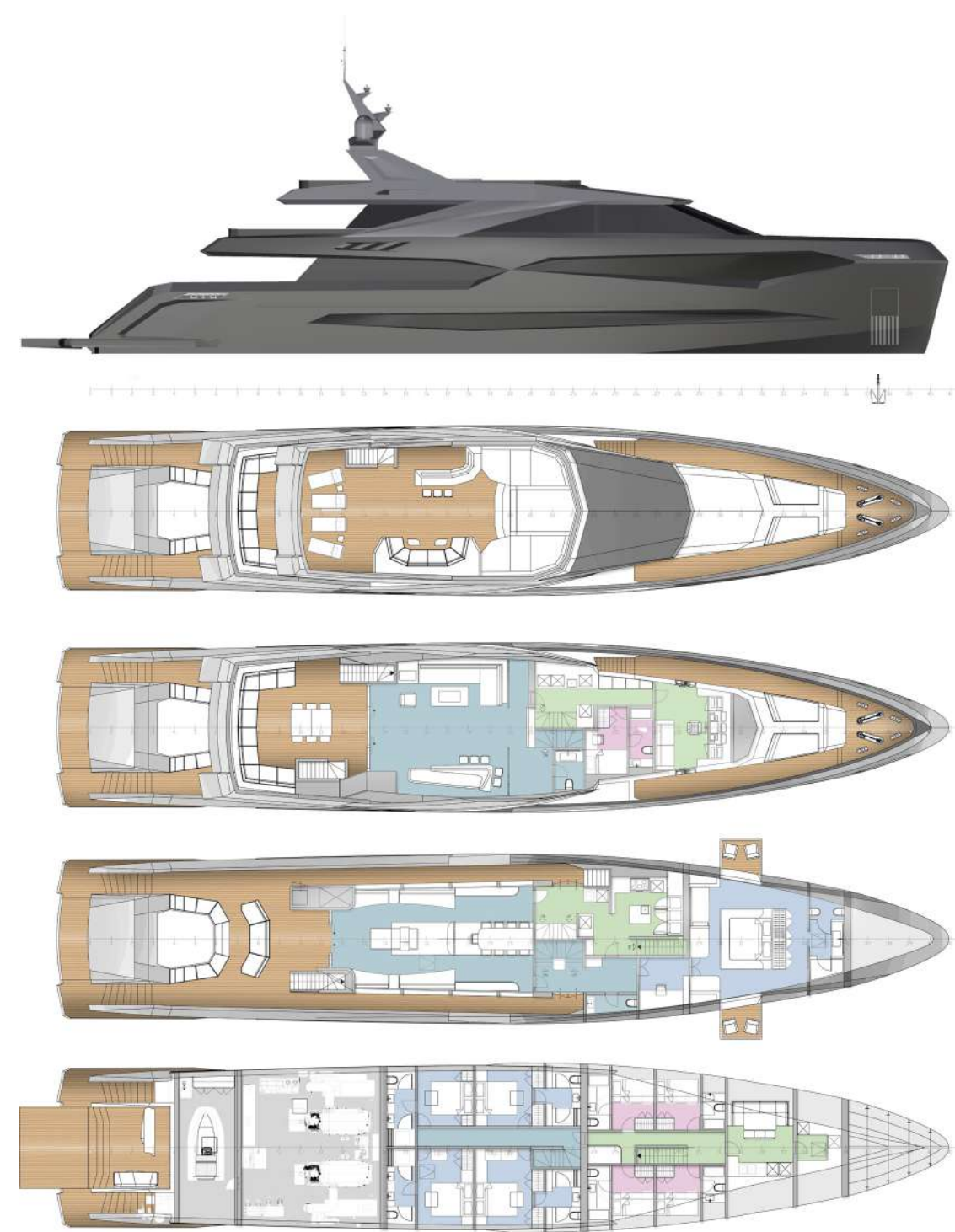







# LEIURUS 60'

## 18MT SAILING YACHT

We aimed to have an unusual, attractive figure in yacht to differentiate our product from others with it's look and design. The traditional perceptions are tried to break down while taking into consideration principles ergonomomy.





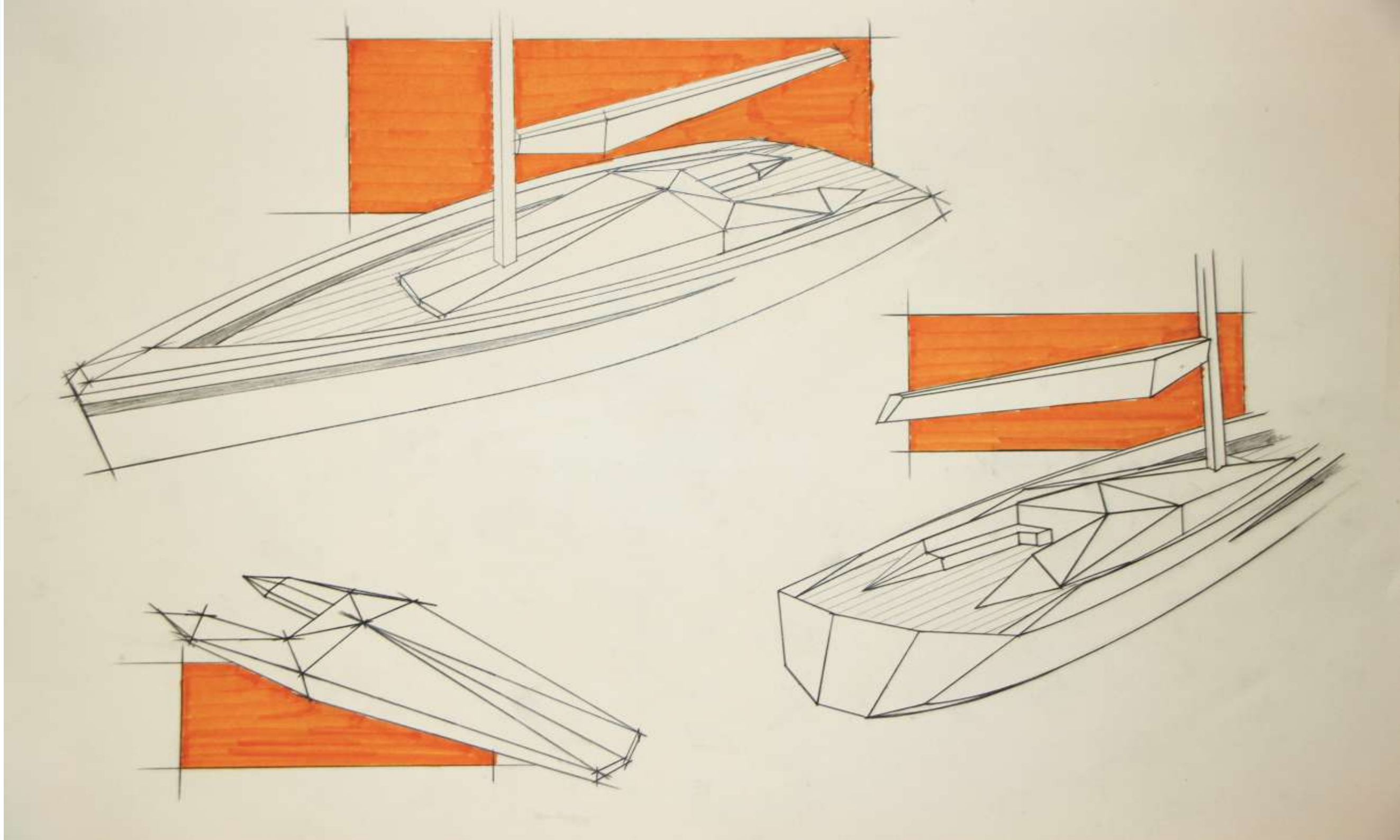
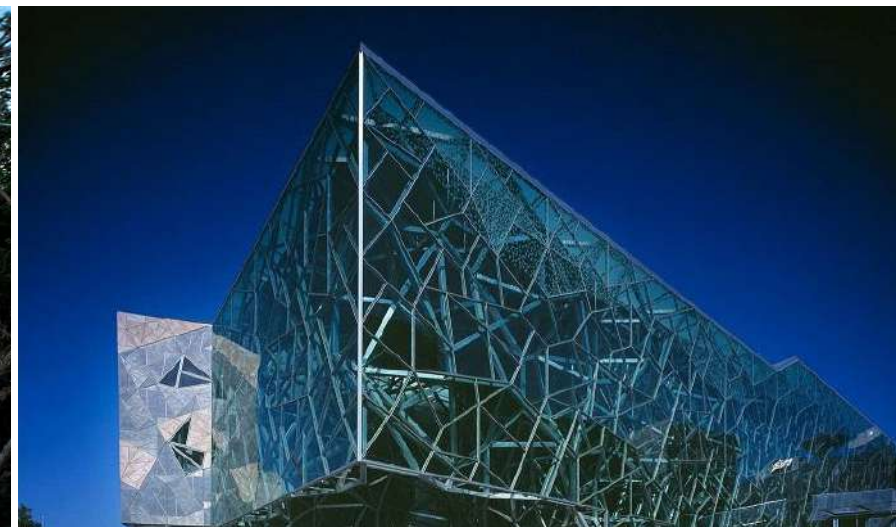







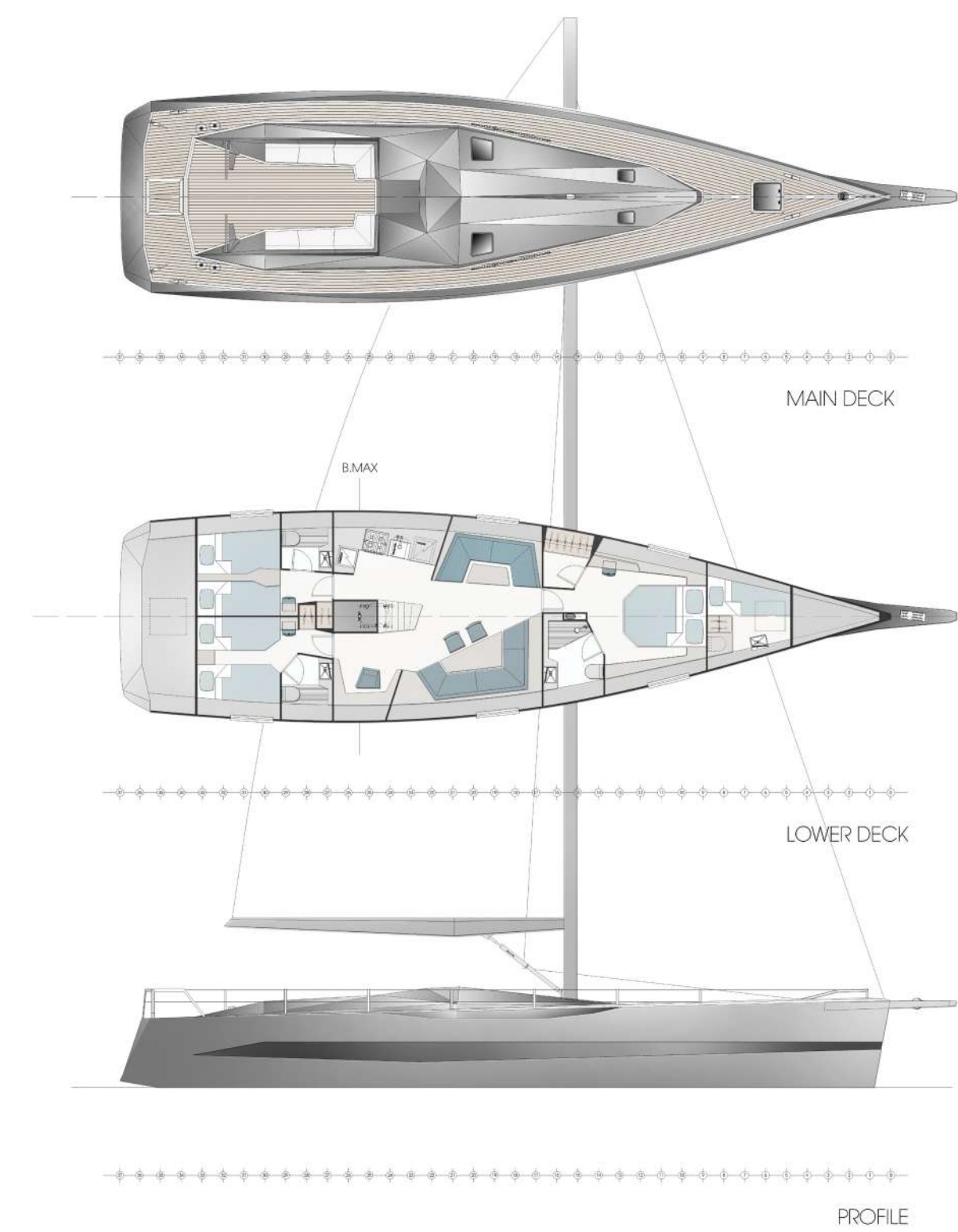







A.CRESPO@DAROCADESIGN.NET  
+34 677 44 75 99

